

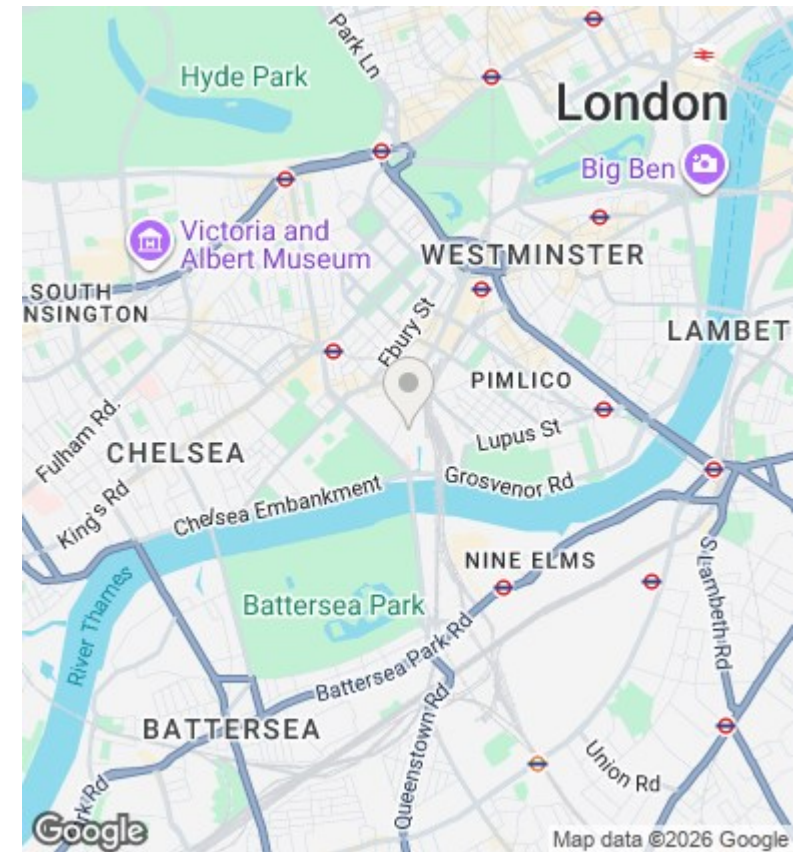

Moore House , Grosvenor Waterside , Gatliff Road SW1W 8DU

£6,350 Per Month

- 3 Bedroom Flat
- Walking Distance to Sloane Square
- Riverside Development
- 24 Hour Concierge
- Secure Underground Parking
- Gym with Spa Facilities
- 24 Hour Security

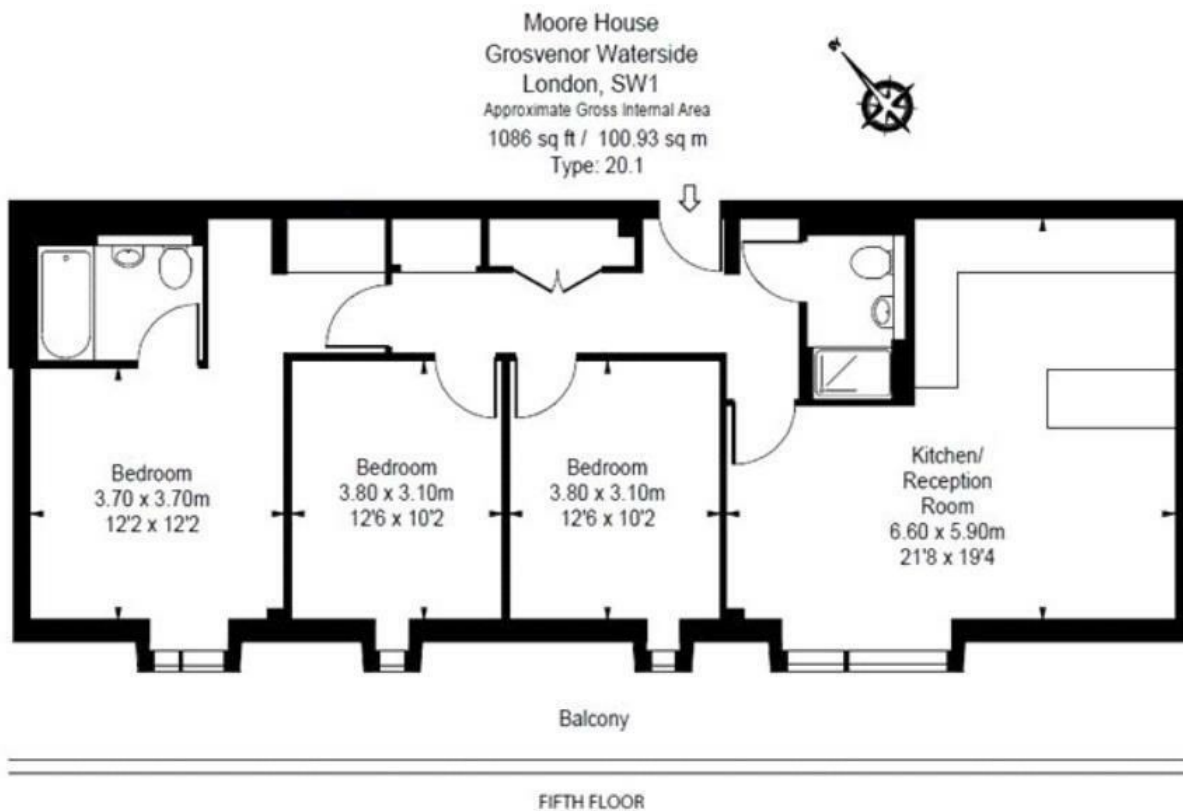

Viewings

Viewings by arrangement only.
Call 02077225022 to make an appointment.

Council Tax Band

G

EPC Rating:

Energy Efficiency Rating		Current	Potential
<i>Very energy efficient - lower running costs</i>			
(92 plus)	A		
(81-91)	B		
(69-80)	C		
(55-68)	D		
(39-54)	E		
(21-38)	F		
(1-20)	G		
<i>Not energy efficient - higher running costs</i>			
England & Wales		EU Directive 2002/91/EC	